



Louisiana Photographic Society (LPS) • P.O. Box 80644 • Baton Rouge, LA 70898 • Website: lphotosociety.com

This Month's Meeting is April 15, to be held at 7950 Independence Blvd.
Board Meeting: 6:00 p.m.
Regular LPS Meeting: 7:00 p.m.

Visitors are encouraged!

Each month LPS has a Competition. There is no competition for December.

Field Trips

Contact David Dendy

Fieldtripcoordinator@lphotosociety.com

Each month: Please submit your favorite photo or editorial to the newsletter to lps@miketilley.com

LPS is a member of the GSCCC. To view the Gulf States Camera Club Council newsletter click on this link: [Newsletters](#)

President's Message

We are making progress towards our two level prints competition. Our last print competition was somewhat confusing and did not get off the ground as expected. Elizabeth has prepared the guidelines for displaying and logging in the prints consistent with our prints competition procedure. Elizabeth and her helpers will be on the floor to organize the prints display for each category and assist if any adjustments are required in displaying the prints. If you have any further suggestions to make it easier to follow the new procedure please let Elizabeth know. Once the new procedure gets off the ground we are expecting a large number of entries for the print competition. We will continue to adjust these guidelines as necessary to make it possible for everyone to participate fairly. Following are the prints display guidelines:

LPS Print Display Guidelines

As specified by the vote of the members as of January 2010 there are two categories for the LPS photographic competition. Within each category, there are two types of entries: Color and Black and White. Category A is for members who have previously earned ribbons or who desire intense competition. Category B is for newer members who have not yet earned ribbons. Members may choose to compete in either category, and may enter either color or black and white prints. Members who choose to compete in Category A may not later decide to compete in Category B without consent of the Competition Committee. You may move from Category B to Category A at any time. Movement from Level B to Level A is *required* if the photographer accumulates 20 points or more in a calendar two-year period.

In order to expedite the process of dealing with the number of prints and the signing in of prints into the proper categories, the following changes will become effective immediately.

Category A prints will go in the first three sections (#1, 2, & 3) of windows (see drawing below). Category B color prints will go in the first section of windows on the east side (#5). Category B black and white prints will go in the next section of windows (#6). Category A black and white will go in the last section of windows (#7). That leaves one section (#4) for expansion as needed.

Each section of windows will have a clipboard for sign in so that fewer people are trying to access the same clipboard. Each clipboard will be labeled in accordance with the signage placed on each section of windows Example: Category B Color Prints, Section 1.

Please look for this information and make sure that you sign

LPS 2010 Officers and Board Members

President
Jay Patel
president@laphotosociety.com

Vice President (and web site coordinator)
Tom Stigall
vicepresident@laphotosociety.com

Treasurer
Sharon Turner
treasurer@laphotosociety.com

Secretary:
Theresa Mullins-Low
secretary@laphotosociety.com

Newsletter Editor:
Michael Tilley
newslettereditor@laphotosociety.com

Immediate Past President –
Robert Connell

2009 Committees Committee Chairs

Competitions: Barry Spears

Exhibits: Kathy Reeves
exhibitcoordinator@laphotosociety.com

Field Trips: David Dendy
fieldtripcoordinator@laphotosociety.com

GSCCC Representatives:
Darelyn Marshall and Gordon Buck

Projection Contest Coordinator:
Gene Bachman
dpcontestcoordinator@laphotosociety.com

Education Coordinator: I
Equipment Coordinator: Greg Hersh
Program Coordinator: Elizabeth Mangham
Refreshment Coordinator: Marie Dendy
Publicity Coordinator: Julie Nall
Librarian:

in on the correct sheet.

A Recap of Some Old Rules:

All prints must be matted and/or mounted, and/or framed such that they are self-supporting for vertical display. The maximum size is 18x24 inches. These are the outside dimensions of the mat or frame, not the image size. Since we are expecting a large number of prints we recommend keeping print size to 16x20 so as to fit two prints in each window; however the maximum size 18x24 prints will be eligible for entry.

The same image may be entered only twice. A resubmission is accepted if the print did not win a ribbon the first time it was entered.

The name of the photographer is not to be visible on any print entered in the competition. Remember that only members may enter the competition.

One last new twist agreed upon by the Competition Committee to be more consistent with the digital projection: Blank cards will be available to you for giving your print a title. Place the card, folded in half in front of your print so that the title shows. Do not put your name on the card.

Hopefully the following drawing of the Garden Center will help explain the window sections.

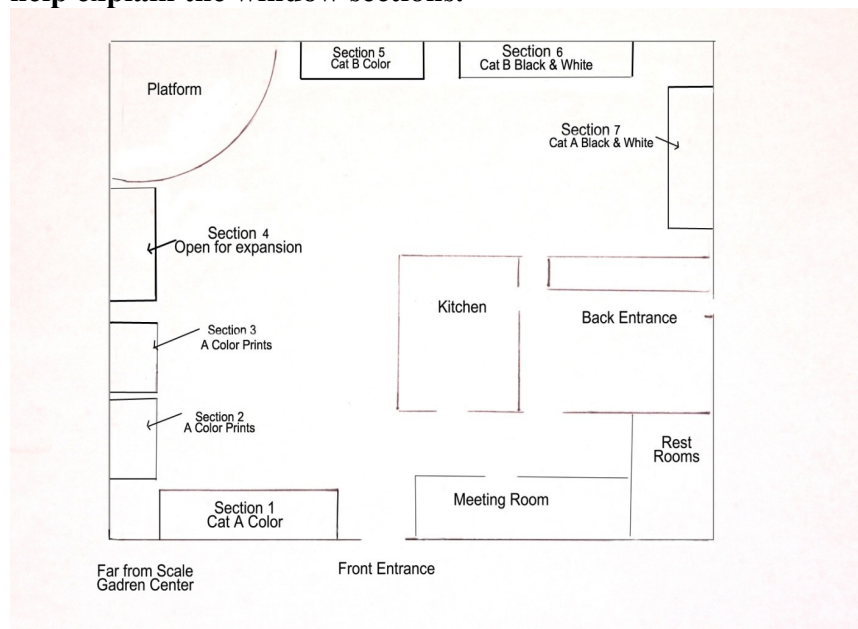

April 15th Guest Speaker Ray Mears – “*Studio in the Wild*”

We have a great photography speaker making a special trip to LPS to present his “Studio in the Wild” photography experiences. He is a Louisiana sportsman, photographer and evangelist dedicated in serving our community in a very unique way. Ray Mears was introduced to the outdoor life as a young boy growing up in the Louisiana delta. While living with his grandparents he hunted, fished, and lived the country life. This gave him a deep appreciation for all things wild and for the beauty all around him. Later, being called to the



ministry, he traveled much of the world in his work as an evangelist. Upon retirement he began wildlife photography as a hobby. He now shares his photographs and speaks to churches and various other groups around the U.S. He has traveled to Oregon, New Mexico, Colorado and to several southern states photographing a wide variety of wildlife and landscapes. He especially enjoys the challenge of photographing everything in its natural environment. This includes such things as monster whitetail deer, turkeys, predators, song birds and other wildlife. He anticipates an adventure every time he enters the woods for he never knows what will fly over him, walk around him or crawl into the blind with him. He calls his work a **Studio in the Wild**. Having hunted and fished most of my life, I enjoy the special bond that exists among sportsmen. We are always looking for a better way to assure success in the woods. In my presentations I try to pass on as much information as possible that will be of value to sportsmen as well as

those who may be interested in the photographic aspect. Photographing a wide variety of wildlife has made it necessary to learn a number of skills and hopefully there will be something useful for all who attend. This, by the way, includes both the failures and the successes. There are many stories that can be told by all who spend much time in the woods. Most are exciting, some are serious, many are humorous, but I never find them dull. I do not find anything dull about looking eye to eye with a trophy whitetail buck or having one stand six feet away and him not know I am there.

Educational Workshop

About fifteen LPS members and visitors attend our “Camera Basics” workshop on March 20th at the Jones Creek Library. A PowerPoint presentation covered the basics of understanding our DSLRs and accessories such as filters, lenses and tripods essential for good photography. A copy of the PowerPoint was provided to all participants. My sincere thanks to David Dendy, Igor Kamalov and Cornell Tramontana for assisting me with the workshop.

Our next Workshop will be on May 15th starting at 9:30 AM at Jones Creek Library. So far we have two one hour presentations lined up for the morning session and looking for two additional presentations for the afternoon session. Gordon Buck will present creating eye catching videos for presenting photographs and Earl Arboneaux will present “Improving your Photographs” covering photography software and plug-ins in creating award winning photographs. Another great workshop is in the works; hope to see a big turnout.

We are in desperate need for the LPS Education Coordinator to continue this program beyond the May workshop. This is a vital function of LPS in helping novice photographers enhanced their skills and on the road to be great photographers. As we head from the LPS “Photographer of the Year” Kathy Reeves, she started out with a point and shoot camera and learned a lot from the LPS members to become a great photographer. There are many among us at the entry level with great potential to become excellent photographers and they need our help. Please give serious thought in helping out our membership.